

# Pipe Saddle (Overstrap)

BS 3974 : Pt 1 : 1974

Material BS 4360 : Gr 43a or equivalent

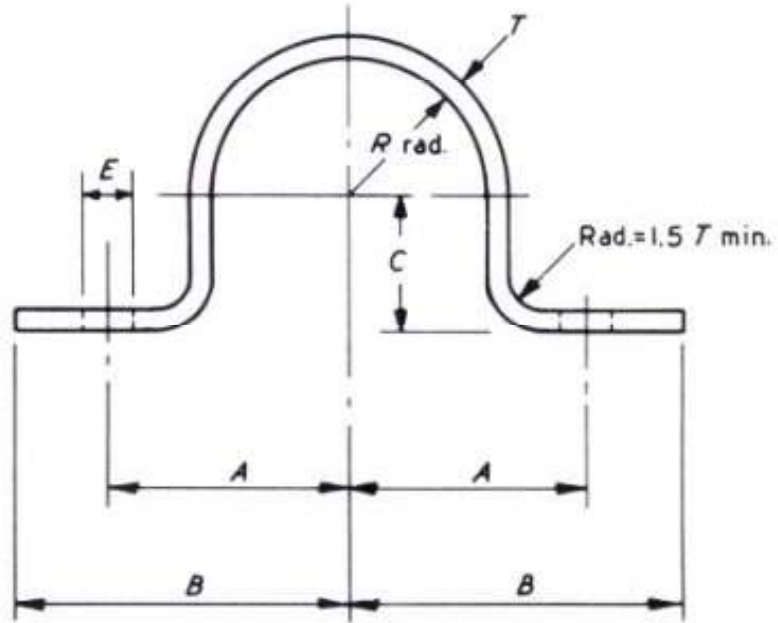

Figure 12

Nom. pipe size	Pipe o.d.	A	B	Steel size W x T	C	R	Hole E	Bolt dia.
15	21.3	53	91	35 x 5	10	11.5	12	10
20	26.9	55	93	35 x 5	13	14	12	10
25	33.7	57	95	35 x 5	16	18	12	10
32	42.4	64	102	35 x 8	20	22	15	12
40	48.3	79	117	35 x 8	23	25	15	12
50	60.3	81	119	35 x 8	29	31	15	12
65	76.1	89	127	45 x 10	36	40	19	16
80	88.9	99	137	45 x 10	43	46	19	16
100	114.3	108	146	45 x 10	55	59	19	16
125	139.7	119	160	60 x 10	68	72	24	20
150	168.3	136	174	60 x 10	82	86	24	20
175	193.7	150	188	60 x 15	95	99	24	20
200	219.1	162	200	60 x 15	107	112	24	20

All dimensions in millimetres